

CODE: **AWO385** v.1.1/II
 NAME: **PS/RS/RSP 3 Enclosure**

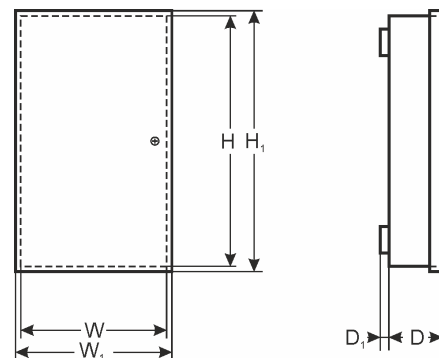

EXAMPLE OF ASSEMBLY:

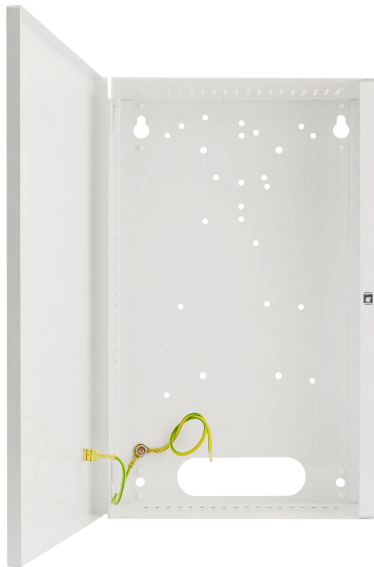

DESTINATION

AWO385 enclosure is designed for mounting built-in power supplies **of the following series:**

RS-15-xx, RS-25-xx, RS-35-xx, RS-50-xx, RS-75-xx, RS100-xx, RS150-xx.

PS-15xxxx, PS-25xxxx, PS-40xxxx, PS-60xxxx, PS-100xxxx, PS-150xxxx, PS-200xxxx.

RSP-100-xx, RSP-150-xx, RSP-200-xx, RSP-320-xx, RSP-500-xx.

The enclosure is made of steel with a thickness of 0.7 mm, in white color RAL9003

TECHNICAL DATA

External dimensions of the enclosure:	W=176, H=276, D+D1=62+8 [+/- 2mm]
External dimensions of the front panel:	W1=180, H1=280 [+/- 2mm]
Weight net/gross:	0,90kg / 1,05kg [+/-0,1kg]
Material description:	sheet steel DC01, thickness: 0,7mm, protection anticorrosion, color: RAL 9003
Destination:	indoor
Closing:	screwed: screw x 1
Notes:	the enclosure includes a set of M3x4 screws – 4 pieces and M4x4 screws - 4 pieces, distance from the wall 8mm
Declarations, warranty:	CE, RoHS, 2 year from the production date